

★  
**GRB**  
**HOUSTON**  
GEORGE R. BROWN CONVENTION CENTER

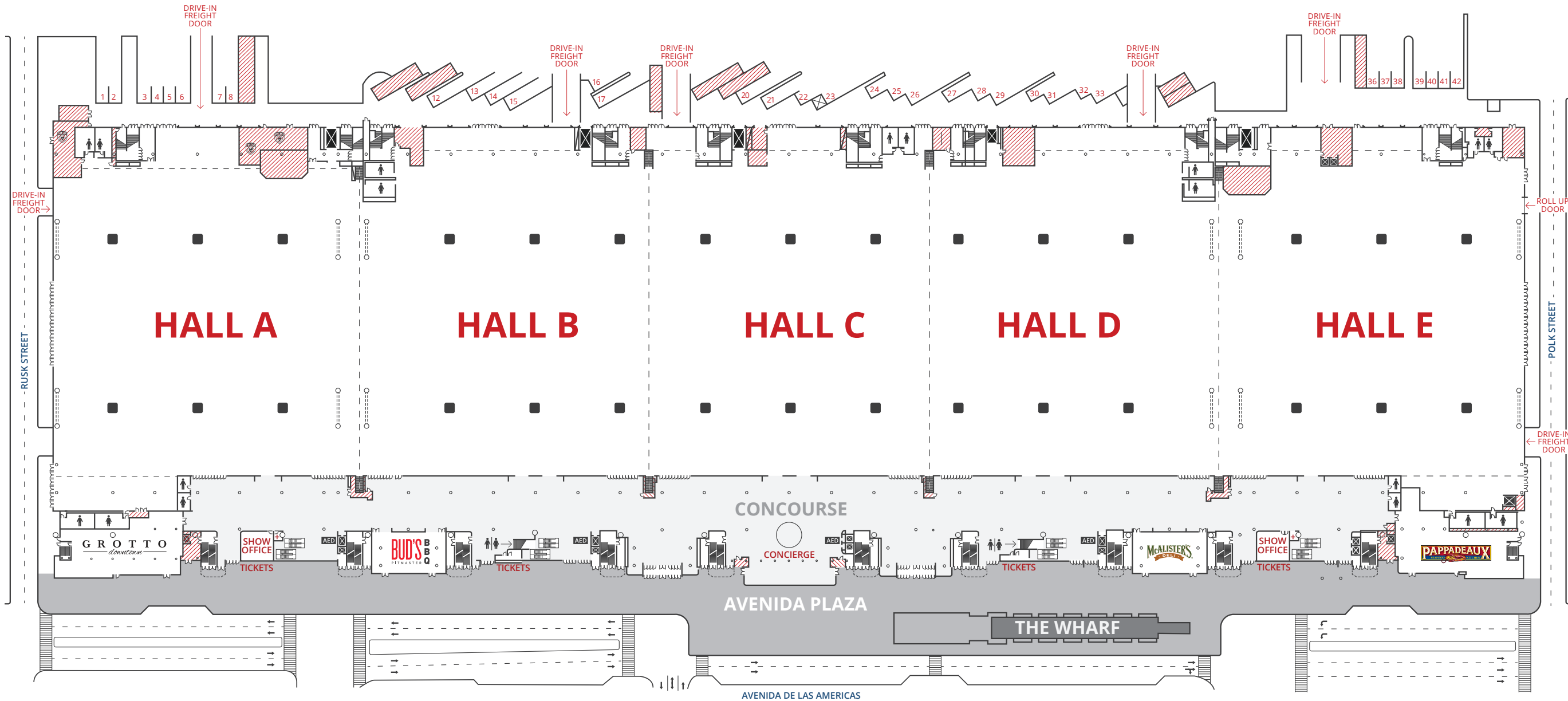

# LEVEL ONE



## LEVEL ONE DIMENSIONS

AREA	USEABLE SQ FT	OVERALL DIMENSIONS FT	CEILING HEIGHT FT
COMBINED HALLS A-E	547,730	1,560 X 429	35
HALL A	114,750	327 X 429	35
HALL B	106,700	304 X 429	35
HALL C	104,400	300 X 429	35
HALL D	106,200	304 X 429	35
HALL E	115,680	327 X 429	35
CONCOURSE	95,000	—	—
AVENIDA PLAZA	99,000	—	—
THE WHARF	115,680	—	—

## LEVEL ONE CAPACITIES

EXHIBIT HALLS	10 X 10 BOOTHS	THEATER	ROUNDS OF 10
COMBINED HALLS A-E	2,860	36,000	24,500
HALL A	590	7,500	5,000
HALL B	570	7,000	5,000
HALL C	540	7,000	4,500
HALL D	570	7,000	5,000
HALL E	590	7,500	5,000

 NON-LEASABLE SPACE

# LEVEL TWO

## LEVEL TWO SQUARE FOOTAGE

AREA	USEABLE SQ FT
SHOW OFFICES 207-211	1,480
CONFERENCE ROOMS 212-215	600
SHOW OFFICES 216-219	1,190
MEZZANINE A-D	90,000
BALCONY A	1,170
BALCONY B	3,000
BALCONY C NORTH	1,500
BALCONY C SOUTH	1,500
BALCONY D	3,000
BALCONY E	2,420

## GARAGE CAPACITIES

GARAGE	AVAILABLE SPACES
NORTH AVENIDA	1,890
SOUTH AVENIDA	1,440
CENTRAL AVENIDA	670
TUNDRA	2,400

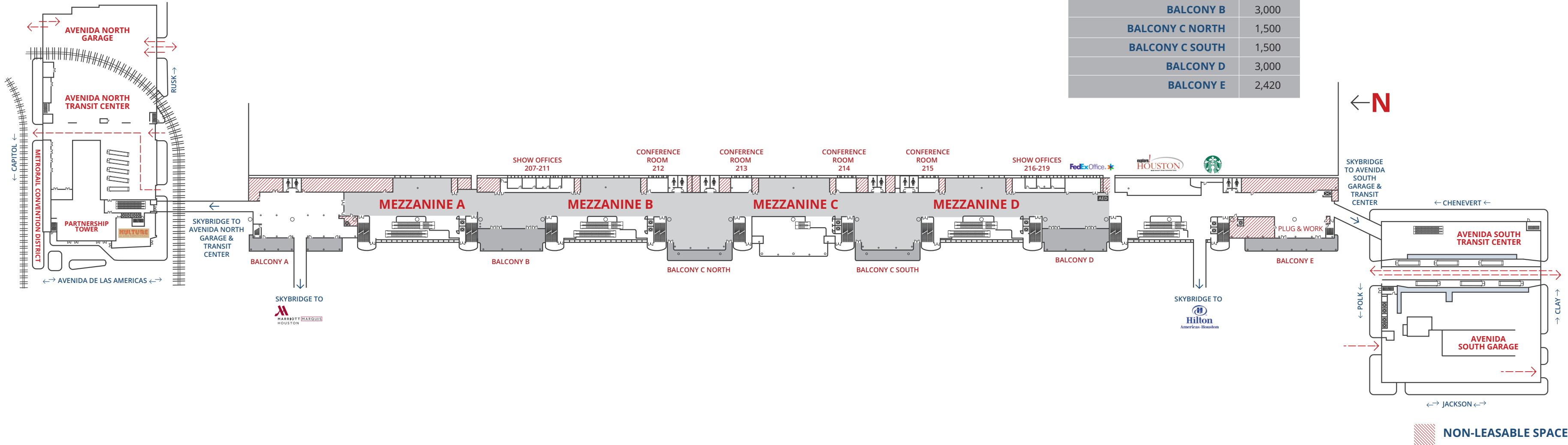

NON-LEASABLE SPACE

# LEVEL THREE

## LEVEL THREE DIMENSIONS

AREA	USEABLE SQ FT	OVERALL DIMENSIONS FT	CEILING HEIGHT FT
HALL A3	124,000	327 X 336	30
HALL B3	99,000	256 X 375	30
ALL BALLROOMS	31,590	270 X 117	25 AT THE WALL 28 IN THE MIDDLE 30 AT THE CENTER
BALLROOM A	10,530	90 X 117	
BALLROOM B	10,530	90 X 117	
BALLROOM C	10,530	90 X 117	
GENERAL ASSEMBLY	5,320	70 X 76	30

## LEVEL THREE CAPACITIES

AREA	10 X 10 BOOTHS	THEATER	ROUNDS OF 10	CLASSROOM
HALL A3	575	7,500	3,500	—
HALL B3	400	7,000	3,000	—
ALL BALLROOMS	—	3,150	2,100	2,152
BALLROOM A	—	1,054	760	690
BALLROOM B	—	1,060	775	650
BALLROOM C	—	1,054	760	690
GENERAL ASSEMBLY	—	3,600	—	—
GENERAL ASSEMBLY A	—	1,200	—	—
GENERAL ASSEMBLY B	—	1,200	—	—
GENERAL ASSEMBLY C	—	1,200	—	—

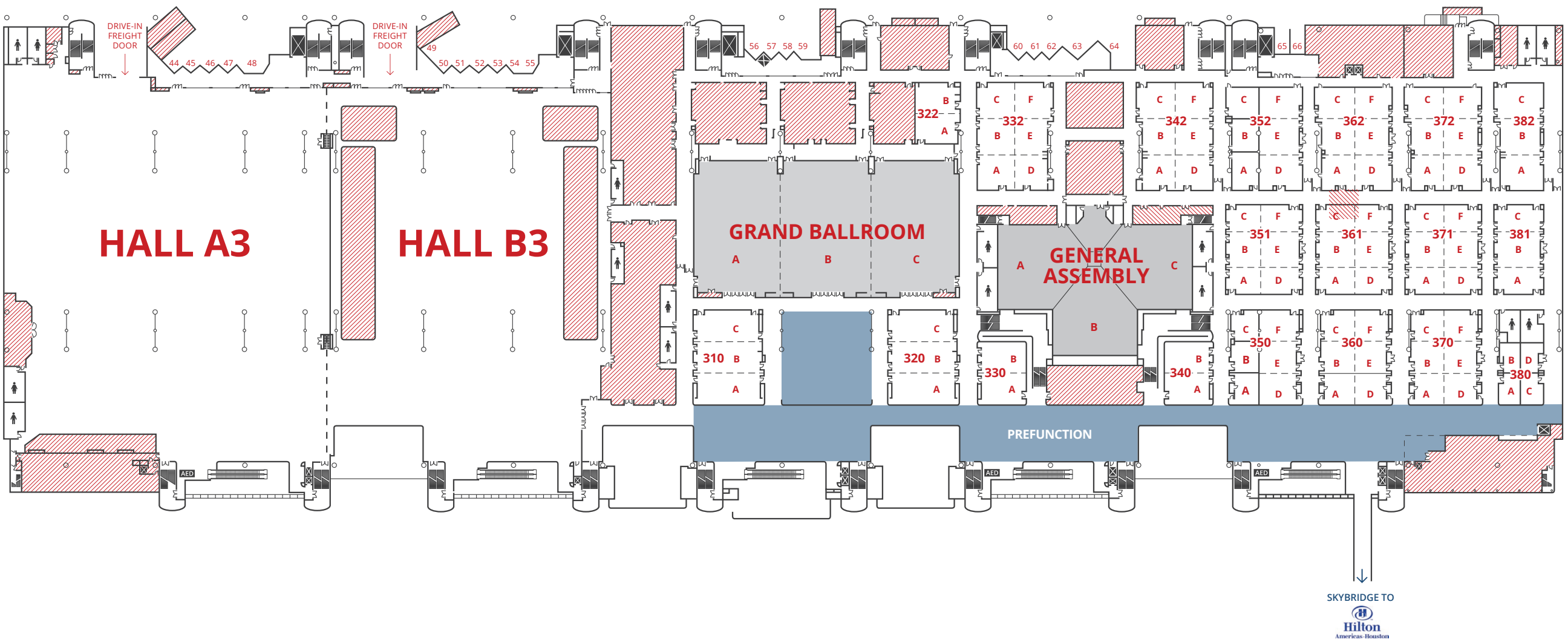

NON-LEASABLE SPACE

# LEVEL THREE MEETING ROOM DIMENSIONS

AREA	USEABLE SQ FT	OVERALL DIMENSIONS FT	CEILING HEIGHT FT
<b>310 ALL SECTIONS</b>	5,848	62 X 95	20
<b>A</b>	1,937	62 X 31	20
<b>B</b>	1,953	62 X 32	20
<b>C</b>	1,958	62 X 32	20
<b>320 ALL SECTIONS</b>	5,848	62 X 95	20
<b>A</b>	1,937	62 X 31	20
<b>B</b>	1,953	62 X 32	20
<b>C</b>	1,958	62 X 32	20
<b>322 ALL SECTIONS</b>	2,360	39 X 61	16
<b>A</b>	1,180	39 X 30	16
<b>B</b>	1,180	39 X 30	16
<b>330 ALL SECTIONS</b>	2,748	44 X 62	16
<b>A</b>	1,371	44 X 31	16
<b>B</b>	1,378	44 X 31	16
<b>332 ALL SECTIONS</b>	7,575	70 X 108	20
<b>A</b>	1,377	38 X 36	20
<b>B</b>	1,342	38 X 35	20
<b>C</b>	1,371	38 X 36	20
<b>D</b>	1,158	32 X 36	20
<b>E</b>	1,144	32 X 35	20
<b>F</b>	1,395	39 X 36	20
<b>340 ALL SECTIONS</b>	2,748	44 X 62	16
<b>A</b>	1,371	44 X 31	16
<b>B</b>	1,378	44 X 31	16
<b>342 ALL SECTIONS</b>	7,216	67 X 108	20
<b>A</b>	1,152	32 X 36	20
<b>B</b>	1,152	32 X 36	20
<b>C</b>	1,370	38 X 36	20
<b>D</b>	1,257	35 X 36	20
<b>E</b>	1,257	35 X 36	20
<b>F</b>	1,370	38 X 36	20

AREA	USEABLE SQ FT	OVERALL DIMENSIONS FT	CEILING HEIGHT FT
<b>350 SECTIONS DEF</b>	3,567	38 X 95	21
<b>A</b>	724	23 X 31	21
<b>B</b>	724	23 X 31	21
<b>C</b>	851	27 X 31	21
<b>D</b>	1,183	38 X 31	21
<b>E</b>	1,189	38 X 32	21
<b>F</b>	1,240	39 X 32	21
<b>351 ALL SECTIONS</b>	6,791	77 X 89	21
<b>A</b>	925	35 X 26	21
<b>B</b>	1,257	35 X 36	21
<b>C</b>	1,006	38 X 26	21
<b>D</b>	925	35 X 26	21
<b>E</b>	1,257	35 X 36	21
<b>F</b>	1,006	38 X 26	21
<b>352 SECTIONS DEF</b>	3,900	40 X 98	21
<b>A</b>	1,014	27 X 38	21
<b>B</b>	866	27 X 33	21
<b>C</b>	940	30 X 31	21
<b>D</b>	1,333	43 X 31	21
<b>E</b>	1,428	40 X 36	21
<b>F</b>	1,347	43 X 31	21
<b>360 ALL SECTIONS</b>	5,827	62 X 95	21
<b>A</b>	963	31 X 31	21
<b>B</b>	974	31 X 32	21
<b>C</b>	976	31 X 32	21
<b>D</b>	969	31 X 31	21
<b>E</b>	979	31 X 32	21
<b>F</b>	981	31 X 32	21
<b>361 ALL SECTIONS</b>	6,183	70 X 88	21
<b>A</b>	925	35 X 26	21
<b>B</b>	1,257	35 X 36	21
<b>C</b>	1,006	38 X 26	21
<b>D</b>	925	35 X 26	21
<b>E</b>	1,257	35 X 36	21
<b>F</b>	1,006	38 X 26	21
<b>362 ALL SECTIONS</b>	6,580	67 X 98	21
<b>A</b>	1,013	32 X 31	21
<b>B</b>	1,164	32 X 36	21
<b>C</b>	1,209	39 X 31	21
<b>D</b>	1,188	38 X 31	21
<b>E</b>	1,245	35 X 36	21
<b>F</b>	1,209	39 X 31	21

AREA	USEABLE SQ FT	OVERALL DIMENSIONS FT	CEILING HEIGHT FT
<b>370 ALL SECTIONS</b>	6,200	66 X 95	21
<b>A</b>	963	31 X 31	21
<b>B</b>	1,092	35 X 32	21
<b>C</b>	1,092	35 X 32	21
<b>D</b>	971	31 X 31	21
<b>E</b>	981	31 X 32	21
<b>F</b>	1,026	32 X 32	21
<b>371 ALL SECTIONS</b>	6,201	70 X 89	21
<b>A</b>	924	35 X 26	21
<b>B</b>	1,257	35 X 36	21
<b>C</b>	919	35 X 26	21
<b>D</b>	924	35 X 26	21
<b>E</b>	1,257	35 X 36	21
<b>F</b>	919	35 X 26	21
<b>372 ALL SECTIONS</b>	6,580	67 X 98	21
<b>A</b>	1,002	32 X 31	21
<b>B</b>	1,164	32 X 36	21
<b>C</b>	1,209	39 X 31	21
<b>D</b>	1,072	35 X 31	21
<b>E</b>	1,245	35 X 36	21
<b>F</b>	1,188	38 X 31	21
<b>380 ALL SECTIONS</b>	516	17 X 31	21
<b>A</b>	498	17 X 30	21
<b>B</b>	516	17 X 31	21
<b>D</b>	498	17 X 30	21
<b>381 ALL SECTIONS</b>	3,754	43 X 88	21
<b>A</b>	1,299	49 X 26	21
<b>B</b>	1,562	44 X 36	21
<b>C</b>	1,291	49 X 26	21
<b>382 ALL SECTIONS</b>	4,610	43 X 108	21
<b>A</b>	1,539	43 X 36	21
<b>B</b>	1,418	39 X 36	21
<b>C</b>	1,756	49 X 36	21

**HARD WALL MEETING ROOMS:**  
350 ABC, 352 ABC and 380 ABDE

# LEVEL THREE MEETING ROOM CAPACITIES

AREA	THEATER	CLASSROOM	ROUNDS OF 10
<b>310 ALL SECTIONS</b>	644	348	360
<b>A</b>	247	120	100
<b>B</b>	255	132	100
<b>C</b>	246	120	120
<b>320 ALL SECTIONS</b>	644	348	360
<b>A</b>	247	120	100
<b>B</b>	238	120	100
<b>C</b>	233	120	120
<b>322 ALL SECTIONS</b>	250	144	200
<b>A</b>	121	68	60
<b>B</b>	109	56	60
<b>330 ALL SECTIONS</b>	305	152	150
<b>A</b>	144	72	70
<b>B</b>	144	72	70
<b>332 ALL SECTIONS</b>	700	432	400
<b>A</b>	127	64	60
<b>B</b>	120	64	60
<b>C</b>	124	64	60
<b>D</b>	87	52	50
<b>E</b>	100	60	50
<b>F</b>	124	64	600
<b>340 ALL SECTIONS</b>	305	152	150
<b>A</b>	144	72	70
<b>B</b>	144	72	70
<b>342 ALL SECTIONS</b>	700	432	400
<b>A</b>	87	52	60
<b>B</b>	100	64	60
<b>C</b>	124	64	60
<b>D</b>	127	64	60
<b>E</b>	120	64	60
<b>F</b>	124	64	60

AREA	THEATER	CLASSROOM	ROUNDS OF 10
<b>350 SECTIONS DEF</b>	442	225	200
<b>A</b>	60	36	40
<b>B</b>	71	36	40
<b>C</b>	73	36	40
<b>D</b>	119	60	60
<b>E</b>	119	60	60
<b>F</b>	123	56	60
<b>351 ALL SECTIONS</b>	588	360	380
<b>A</b>	86	42	50
<b>B</b>	120	64	60
<b>C</b>	88	42	50
<b>D</b>	86	42	50
<b>E</b>	120	64	60
<b>F</b>	82	42	50
<b>352 SECTIONS DEF</b>	490	281	230
<b>A</b>	90	49	40
<b>B</b>	70	35	40
<b>C</b>	88	46	40
<b>D</b>	129	60	70
<b>E</b>	140	80	70
<b>F</b>	129	68	70
<b>360 ALL SECTIONS</b>	616	408	380
<b>A</b>	85	44	60
<b>B</b>	83	52	50
<b>C</b>	86	36	50
<b>D</b>	85	44	60
<b>E</b>	85	36	60
<b>F</b>	82	40	60
<b>361 ALL SECTIONS</b>	588	360	380
<b>A</b>	86	42	50
<b>B</b>	120	64	60
<b>C</b>	88	42	50
<b>D</b>	86	42	50
<b>E</b>	120	64	60
<b>F</b>	82	42	50
<b>362 ALL SECTIONS</b>	644	408	400
<b>A</b>	79	52	60
<b>B</b>	100	60	60
<b>C</b>	112	64	60
<b>D</b>	112	52	60
<b>E</b>	120	64	60
<b>F</b>	112	56	60

AREA	THEATER	CLASSROOM	ROUNDS OF 10
<b>370 ALL SECTIONS</b>	616	408	360
<b>A</b>	85	44	60
<b>B</b>	83	52	50
<b>C</b>	86	36	50
<b>D</b>	85	44	60
<b>E</b>	85	36	60
<b>F</b>	82	40	60
<b>371 ALL SECTIONS</b>	588	360	380
<b>A</b>	86	42	50
<b>B</b>	120	64	60
<b>C</b>	88	42	50
<b>D</b>	86	42	50
<b>E</b>	120	64	60
<b>F</b>	82	42	50
<b>372 ALL SECTIONS</b>	644	408	400
<b>A</b>	79	52	60
<b>B</b>	100	60	60
<b>C</b>	112	64	60
<b>D</b>	112	52	60
<b>E</b>	120	64	60
<b>F</b>	112	56	60
<b>380 ALL SECTIONS</b>	50	24	30
<b>A</b>	47	24	30
<b>C</b>	50	24	30
<b>D</b>	42	21	30
<b>381 ALL SECTIONS</b>	390	255	210
<b>A</b>	130	68	60
<b>B</b>	160	96	90
<b>C</b>	126	68	60
<b>382 ALL SECTIONS</b>	494	244	260
<b>A</b>	164	84	90
<b>B</b>	140	80	80
<b>C</b>	184	104	90

For more information, please visit  
[WWW.GRBHOUSTON.COM](http://WWW.GRBHOUSTON.COM)

# LEVEL ONE

COLUMN DIMENSIONS AND POSITIONS

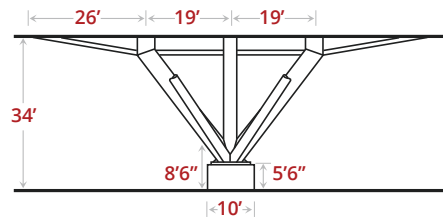

COLUMN POSITION FACING SIDES OF BUILDING

# LEVEL THREE

COLUMN DIMENSIONS AND POSITIONS

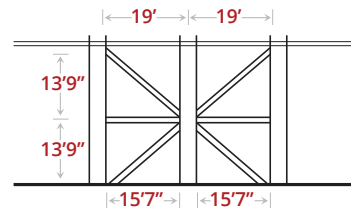

COLUMN POSITION FACING SIDES OF BUILDING

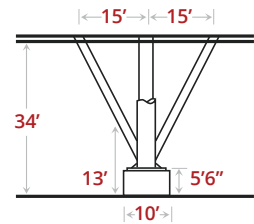

COLUMN POSITION FACING ENTRANCE OR REAR FREIGHT DOORS

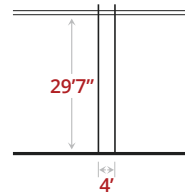

COLUMN POSITION FACING ENTRANCE OR REAR FREIGHT DOORS

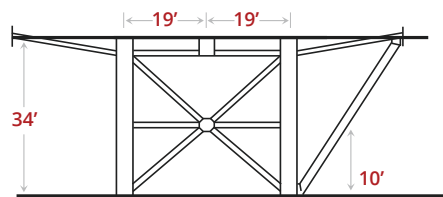

COLUMN POSITION FACING SIDES OF BUILDING HALLS A,B,D,E ONLY

## LEVEL 1

DRIVE-UP LOADING DOCKS:	42
FLOOR LOAD LIMIT:	1,000 LB PER SQ FT

## LEVEL 3

DRIVE-UP LOADING DOCKS:	24
FLOOR LOAD LIMIT:	400 LB PER SQ FT

# FREIGHT ACCESS AND ELEVATORS

## HALL A

5 FREIGHT DOORS	
DRIVE-IN DOORS	BACK: 14'H X 19'W SIDE: 25'H X 30'W
FREIGHT ELEVATORS	BACK OF HALL A: 10'H X 10'W X 13'3"D 12,000 LB LOAD LIMIT  CONCOURSE A: 10'H X 10'8"W X 10'9" 12,000 LB LOAD LIMIT

## HALL B

5 FREIGHT DOORS	
DRIVE-IN DOOR	14'H X 24'W
FREIGHT ELEVATORS	BACK OF HALL B: 10'H X 11'8"W X 20'4"D 20,000 LB LOAD LIMIT  CONCOURSE B: 10'H X 10'8"W X 10'9" 12,000 LB LOAD LIMIT

## HALL C

3 FREIGHT DOORS	
DRIVE-IN DOOR	19'H X 30'W
FREIGHT ELEVATORS	BACK OF HALL C: 10'H X 11'8"W X 20'4"D 12,000 LB LOAD LIMIT

## HALL D

5 FREIGHT DOORS	
DRIVE-IN DOOR	14'H X 24'W
FREIGHT ELEVATORS	BACK OF HALL D: 10'H X 10'W X 13'10"D 12,000 LB LOAD LIMIT  CONCOURSE D: 10'H X 10'W X 10'10"D 12,000 LB LOAD LIMIT

## HALL E

7 FREIGHT DOORS	
DRIVE-IN DOORS	BACK: 14'H X 18'W SIDE: 25'H X 30'W
FREIGHT ELEVATORS	BACK OF HALL E: 10'H X 11'8"W X 19'9"D 20,000 LB LOAD LIMIT  CONCOURSE E: 10'H X 10'8"W X 10'9"D 12,000 LB LOAD LIMIT

## HALL A3

5 FREIGHT DOORS	
DRIVE-IN DOOR	19'H X 24'W
FREIGHT ELEVATORS	BACK OF HALL A3: 10'H X 10'W X 13'3"D 12,000 LB LOAD LIMIT  CONCOURSE A3: 10'H X 10'8"W X 10'9" 12,000 LB LOAD LIMIT

## HALL B3

5 FREIGHT DOORS	
DRIVE-IN DOOR	19'H X 24'W
FREIGHT ELEVATORS	BACK OF HALL B3: 10'H X 11'8"W X 19'9"D 20,000 LB LOAD LIMIT



THE WHARF

For more information about locations and access, please contact your Convention Service Manager.



## GEORGE R. BROWN CONVENTION CENTER

The George R. Brown Convention Center opened on the east side of downtown Houston on September 26, 1987. The building was named for internationally recognized entrepreneur, engineer, civic leader, philanthropist and Houstonian George Rufus Brown (1898-1983), who donated six of the 11 blocks necessary to build the GRB. The first convention held was the American Society of Travel Agents beginning in October of that year. In July 2001, ground was broken on a joint effort to expand the convention center and build an adjacent 1,200-room convention headquarters hotel. After 27 months of construction, the GRB grew from 1.15 million square feet to 1.8 million square feet. Three exhibit halls and more meeting rooms were added. The expansion was completed on December 3, 2003. Ground was broken yet again in June 2014 to fulfill the goals outlined in the GRB 2025 Master Plan. By adding more connectivity within the GRB and to the surrounding neighborhoods, a captivating experience for visitors and Houstonians alike is created.

Houstonfirst.

VISITHOUSTON

## HOUSTON FIRST CORPORATION

Houston First Corporation operates the city's finest convention and arts facilities to position Houston as a world-class destination. In 2014, Houston First and the Greater Houston Convention & Visitors Bureau aligned their operations to provide a single clear voice for Houston. Houston First owns the Hilton Americas-Houston hotel and manages 11 city-owned buildings, plazas and parking facilities. Properties include the George R. Brown Convention Center, Miller Outdoor Theatre, Wortham Center and Jones Hall for the Performing Arts. For more information, log on to [HoustonFirst.com](http://HoustonFirst.com) and [VisitHouston.com](http://VisitHouston.com).

**GEORGE R. BROWN CONVENTION CENTER**  
**1001 AVENIDA DE LAS AMERICAS, HOUSTON, TEXAS 77010**

**TOLL FREE: 800-427-4697 | MAIN: 713-853-8000 | FAX: 713-853-8090 | EMAIL: [ccinfo@houstonfirst.com](mailto:ccinfo@houstonfirst.com)**  
**[WWW.GRBHOUSTON.COM](http://WWW.GRBHOUSTON.COM)**